

**1. Compressor Type**

Model	FZ59E1G-U
Displacement (cc)	5.9
Nominal voltage limits	115V/60Hz
Refrigerant	R600a
Appliance type	Low back pressure
Cooling Type	Static cooling
Expansion Device	Capillary pipe
Motor Type	RSIR

**2. Compressor Design Parameter**

Refrigerant Oil Type	Ester Synthetic Oil POE
Net mass ( oil included )	5.8±0.4kg
Discharge tube (Inner Diameter)	Φ4.91±0.1mm
Suction tube (Inner Diameter)	Φ6.5±0.1mm
Process Tube (Inner Diameter)	Φ6.5±0.1mm
Material for Tube	Copper
Base plate type	European type (170*70)
Water tray holder	Without
Shielding Gas	Negative pressure
Residual impurities	≤50mg
Residual moisture ( oil included )	≤100mg
Starting Ability	98V [0.95/0.95 Mpa ( abs ) ](25°C)

**3. Electric wiring diagram (RSIR)**

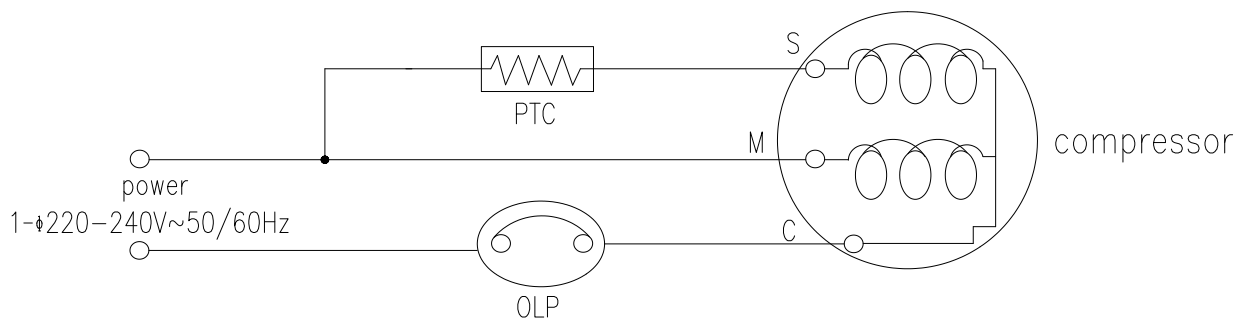

4. Compressor diagram

Accessory assembly diagram (RSIR)

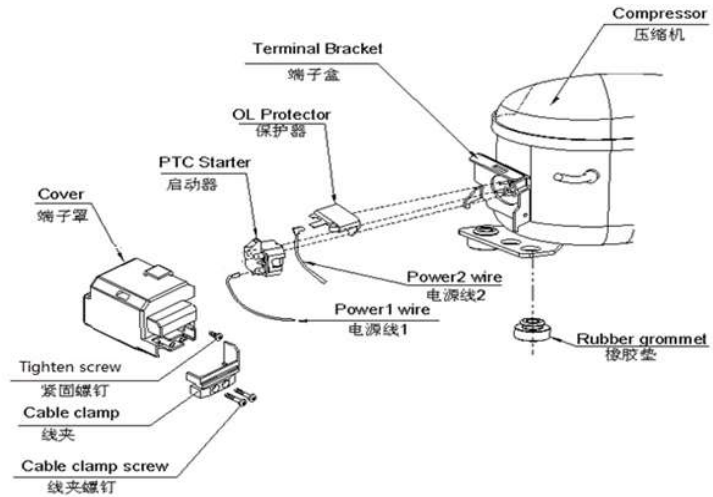

Compressor outline

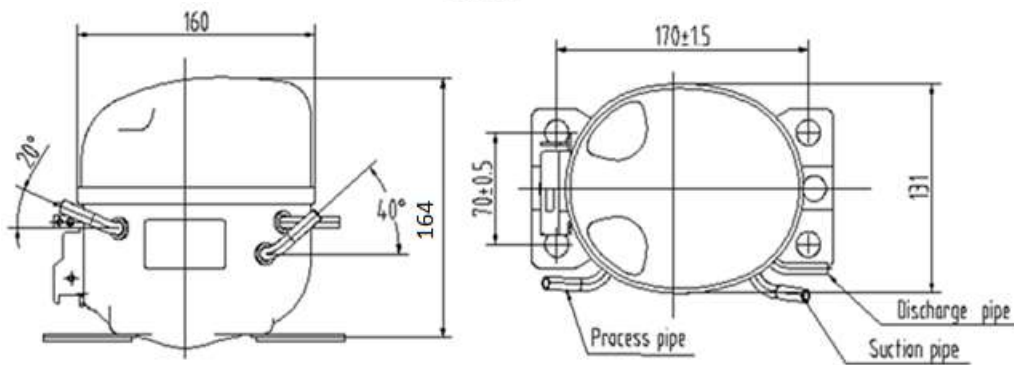

5. Performance Parameters

Displaceme (cm <sup>3</sup> )	Test power supply	Capacity (W)	Input power(W)	COP(W/W)	Sound level [dB(A)]	Vibration (m/s <sup>2</sup> )	Back Pressure
		≥95%	≤115%	≥95%			
5.90	115V/60Hz	112	73	1.53	≤42	≤0.6	LBP

The test condition:

Test condition (ASHRAE)	LBP	MBP	HBP
Evaporating temperature	-23.3 °C	-6.7 °C	7.2 °C
Condensation temperature	54.4 °C	54.4 °C	54.4 °C
Ambient temperature	32.2 °C	35 °C	35 °C
Suction temperature	32.2 °C	35 °C	35 °C
Sub cooling temperature	32.2 °C	46.1 °C	46.1 °C

6. Packing storage and transportation

Amount	140 SETS/PALLETS
Vehicle	Train Or Automobile
Stacking Capacity	2
G.W.	847
N.W.	812
Cubic Measure m <sup>3</sup>	1.2
Dimensions L×W×H(mm)	1140×940×1080

**7. Cautions**

Ambient temperature	-5~43℃
Evaporating temperature	-35~-10℃
Voltage range	98~140V
Max. pumping pressure	0.92 Mpa
Max. condensing temperature	65℃
Max. winding temperature	130℃
Max. Shell temperature	90℃
Max. discharge temperature	120℃
Flood back amount of refrigerant	No flood back
Intermittent operation item	ON: > 5 minutes, OFF: > 5 minutes or more
Operation cycle times	< 200,000
Angle of slope	within 5°
Pressure difference at start-up	The pressure should be balanced at the high-pressure and low-pressure sides at start-up. If pressure is not balanced, you need to check compressor's starting performance.

**8. Delivery List for Components**

Number	Name	Specification	Amount	Remark
1	Compressor	FZ59E1G-U	1	
2	PTC		1	
3	OLP		1	
4	Terminal cover		1	
5	Earthing screw		1	
6	Grommet		4	

Remark:

Each component is independently packaged instead of installed on compressor. If there is no figure in AMOUNT column, the corresponding component is not included for this compressor type.

**9. Environmental Requirement**

Regarding compressor and fitting

- 1、PAHs request : PAHs ( II ) : BaP content <1ppm、16 kind of PAH(EPA) total quantity <10ppm;
- 2、REACH laws and regulations request: SVHC the limit is smaller than 1000ppm;
- 3、The phthalic acid salt (fat) requests : 18 item of deleterious substance limits request are smaller than 1000 ppm;

### 10. Compressor operation envelope

